

# **144-core wall-mounted optical cable junction box**

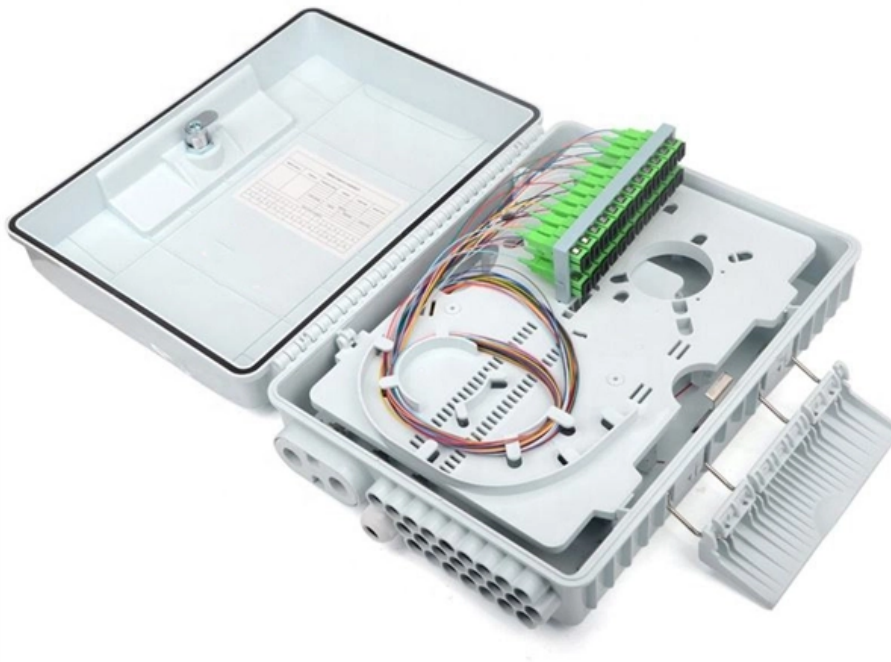



## **144-core wall-mounted optical cable junction box**

---

## **Connectorized Fiber Optic Cabinet, 144 cores**

---

Our 144-core Pedestal/ Wall Mounted Connectorized solution offers a compact and versatile fiber optic connectivity option. With connectorized adapters and pigtails,

## **Wall mount optical distribution frame cabinet up to 144 core capacity**

---

Outdoor wall type fiber optic distribution frame is mainly used for connecting the outdoor optical cables, optical patch cords and optical pigtails. It can be wall mounted or pole mounted, and facilitates the



## **144 Cores Optical Cross Connection Cabinet**

---

SEESUO 144-218 cores cabinets are suitable for optical transmission network and the optical access network, to realize the connection and dispatch of the trunk optical cable and distribution optical fiber.

## **144 Cores ISO Certification Horizontal Plastic Cable**

---

We are Cable Connector manufacture and supplier, provide 144 Cores ISO Certification Horizontal Plastic Cable Connector Junction Box on sale, factory price.

## **144 Way Optical Fibre Wall Splice Enclosure , BFP**

---

144 way Fibre Optic Wall Splice Enclosure (Building Flexibility Point). 12 x 12 Fibre Splice Management Cassettes included. Incorporated into the BFP is the facility of splicing multiple external or internal



## **Fiber Termination Box: 8-96 Cores, IP65/IP68 Protection**

---

Fiber termination boxes are widely used in FTTx (Fiber to the x) cabling for both fiber management and cable organization. They come in various sizes and

## **Premium-Line 24 ports Wall Mounted Fiber Optic Box**

---

Premium Line 24 ports wall mount fiber optic box is used for the direct termination of fibers. Box include two separate sections.

## **144 Cores Optical Cross Connection Cabinet**

---



The cabinet is with excellent performance, safe and reliable, flexible scheduling, and is suitable for various optical communication networks, especially FTTH networks. These optical cross connecting

## Wall Mount Fiber Patch Panels

---

We offer NEMA rated enclosures for top-of-the-line quality and durability on indoor and outdoor fiber patch panels. A loaded fiber optic wall mount termination box comes equipped with cable routing

## Metal Joint Junction Box, Splicing Box Manufacturer

---

ADSS/OPGW Metal Junction Box The ADSS/OPGW Metal Junction Box, also known as a splicing box or Metal Joint Junction Box, is designed to house fiber core



## **Wall Mounted 144 Core Fiber Optic Cabinet ODC Pole**

---

High quality Wall Mounted 144 Core Fiber Optic Cabinet ODC Pole Fiber Distribution Cabinet from China, China's leading SMC Cabinet Wall Mounted product, with

## **24 48 96 144 Core PP Dome WallMount Outdoor Fiber**

---

FOSC400B4 fiber optic splice closures are specially designed to protect joints of optic cable. Excessive fibers can be stored in storage baskets behind the splice

## **FDT 288 cores optic distribution cabinet FTTH junction box with**

---



FDT 288 cores optic distribution cabinet FTTH junction box with Insertion Module PLC Splitter. Ideal for FTTX networks. Wall/Pole Mounted. Durable & Efficient., Alibaba

## **Vertical Joint Box/ Dome Type Splice Closure, Up to 144 Cores.**

---

**Product Description** It protects fiberoptic splices while providing fast and easy no-cost re-entry. It can be installed on aerial, in manholes, ducts and mounted on poles. The Closure provides reliable sealing

## **96/144 Cores IP68 Pole/Wall/Underground Installation**

---

**Flexible Ports:** Includes 4 circular cable ports and 1 oval port for cable loop-through. Suitable for pole, wall, and underground installations with excellent



## **Wall Mounted Optical Fiber Cable Joint Closure 144**

---

High quality Wall Mounted Optical Fiber Cable Joint Closure 144 Core 4 In 24 Out IP68 FTTH Box from China, China's leading product market Fiber Optic Splice

## **96 Core Fiber Splice and Distribution Closure with**

---

The 5 port aerial dome Fiber splice closure provides space for 96 core optical cable splicing and a 1x32 splitter, allows for 7 - 18mm cable entry

## **ODF-E-144 8U optical distribution frame 144 Cores**

---

144 Cores Optical Distribution Frame Overview Fiber Management Tray also called ODF Distribution Box, Integrated Splicing and Distribution ODF. It is mainly used



## **96/144 Cores IP68 Pole/Wall/Underground Installation**

---

The Dome Type Fiber Splice Closure is a reliable and versatile solution for ensuring secure and efficient optical fiber connections in various

## **URM LH 144S Wall-mounted Optical Distribution Box**

---

The URM LH 144S optical distribution box is designed for the placement of 144 optical splices indoor and outdoor. The distribution box may be complemented by

## **Outdoor Fiber Optic Cabinet 144 Core for FTTX**



## Networks

---

Outdoor Fiber Optic Cabinet with 144 Core provides reliable FTTx Solutions. Durable, temperature-resistant, and versatile for various fiber numbers. Shop now!, Alibaba

## High Quality FTTH Outdoor Fiber Optic Cross Connect

---

Fiber Cabinet is an outdoor optical device designed specifically for outdoor fiber optic access networks, which enables the connection, splicing, storage, and

## ADSS/OPGW Metal Junction Box

---

FOSC Metal Joint Junction Box For Pole and Tower ADSS/OPGW 12, 24, 48, up to 144 Cores Aerial Fiber Optic Cable Splice Closure, Contact Us for Details Now!



## ADSS/OPGW Metal Junction Box

---

The ADSS/OPGW metal junction box is also called a splicing box that is designed to house the fiber core splices to the outdoor intermediate optical cable leading to

### Contact Us

---

For datasheets, pricing, or custom optical networking solutions, please visit:  
<https://www.entrenamientointeligente.es>