

# Cable tray changes

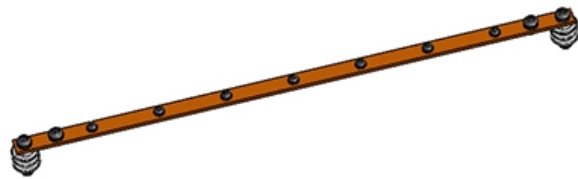



## Overview

---

NEMA VE-1 has been revised and updated, with many significant changes that effect the way trays are tested, load rated and specified. In this installment of our Code Corner series, Ryan Mayfield focuses on the 2023 National Electrical Code (NEC) changes concerning cable trays, particularly section 690. maintain spacing or to keep cables in place when the tray is ect the minimum bend radius for cables as they exit the bottom of the cable tray. A rung spacing of 6 to 9 inches (150 to 230 mm) is preferable when the cable tray cont d for instrumentation and control applications that require. When developing our cable support OBO can offer reliable solutions for systems, three attributes are at the routing and fastening cables securely core of what we do: efficiency, resil- for each of these installation challeng-ience and safety. In this guide, we explain what cable trays are, the main types available, how to choose the correct size and duty rating, and what to consider when designing a cable tray.



## Cable tray changes

---

# How to Replace Cable Trays: Process & Safety Tips

---

A simple guide on how to replace cable trays. Learn about the process, safety tips, and what to look out for. Ideal for electricians and

## The 2026 Snow Load Shock Forces an Immediate ASCE 7-22

---

Designing roof-mounted strut and cable tray systems for real-world conditions means accounting for snow, ice, and wind in a structured calculation process. ASCE 7-22 shifts snow load design to a



## Latest Technologies in Cable Tray Manufacturing

---

Cable tray manufacturers are at the forefront, adopting new materials and designs to enhance the efficiency and safety of cable routing systems. This

## Types of Cable Trays - Advantages, Applications and Sizes

---

Explore the types of cable trays, their advantages, applications, and standard sizes. Learn how they improve cable management and support various industries.

## Cablofil FASLOCKXLDC Hot Dip Galvanised Steel Wire Cable Tray

---

Hot dip galvanised steel bend connector for directional changes in wire mesh cable trays. Horizontal hinged joint supports flexible routing for 300-600 mm trays with corrosion resistant, halogen free



## **Cable Tray Types and Sizes**

---

Explore various cable tray types and sizes for electrical installations. Learn about ladder, perforated, solid-bottom, wire mesh, and channel trays in this complete

## **Cable Tray Systems Explained: The Right Solution for**

---

In this guide, we explain what cable trays are, the main types available, how to choose the correct size and duty rating, and what to consider when designing a

## **A Guide to Cable Tray Accessories and Their**



## Functions

---

Explore a detailed guide to cable tray accessories and understand their uses in ensuring safety, stability, and efficiency in electrical system

## Code Corner: 2023 NEC Article 690.31 (C) and (C) (2)

---

In this installment of our Code Corner series, Ryan Mayfield focuses on the 2023 National Electrical Code (NEC) changes concerning cable trays,

## Innovative Cable Tray Designs for Modern

---

As infrastructure advances, cable tray systems play a crucial role in efficient cable management. By adopting innovative designs and materials and following best



## **Secretlab Announces New Standing Desk With Cable Tray**

---

The new standing desk by Secretlab goes all-in on making arranging your workspace easy. A stainless steel strip runs the full length of the table on the

## **NEMA VE-1: Changes & Commentary , Cable Tray Institute**

---

NEMA VE-1 has been revised and updated, with many significant changes that effect the way trays are tested, load rated and specified. NEMA VE-1 has been harmonized with the Canadian Standards

## **How to Install Cable Tray: A Comprehensive Guide to Different Cable**

---



Welcome to our step-by-step guide on installing cable trays! In this video, we'll explore the different types of cable trays available and provide detailed instructions for their installation.

## **Cablofil Electro-Zinc Steel Cable Tray Radius Support 150mm**

---

Electro-zinc steel radius support for wire mesh cable trays, enabling horizontal hinged direction changes. Compatible with 100-600 mm trays with 50 mm side height for controlled cable routing.

## **Mastering Cable Tray Installation , Step-by-Step Guide for a Seamless**

---

Learn how to install cable trays correctly. Get the ultimate step-by-step guide on setting up a seamless and reliable cable management system.



## **Best Practices for Installing Cables in Trays**

---

Learn the best practices for installing cables in trays. This guide covers essential steps, technical requirements, and key details for efficient cable

## **Cable Tray Failures: Types, Causes, and Prevention**

---

However, like any other infrastructure, cable trays are prone to failures that can result in serious safety hazards, financial losses, and downtime.

## **Complete cable tray manual for electrical engineers and**

---



How to design cable tray? Most projects are roughly defined at the start of cable tray design. For projects that are not 100 percent defined before design start, the cost

## **Cable Tray Installation and Maintenance Considerations**

---

Learn about effective Cable Tray Installation and Maintenance. Get practical tips for planning, fitting, and looking after your cable trays.

## **The 2026 Snow Load Shock Forces an Immediate ASCE 7-22**

---

The shift from older snow load maps to the new, more aggressive ground snow load provisions means that many existing Unistrut and cable tray support designs--often based on P1000/P1001 legacy



## **Cable Tray Technical Guide A practical guide to product selection and**

---

Cable Tray Technical Guide A practical guide to product selection and installation This guide for engineers and installers has been developed by ABB as a practical reference regarding cable tray

## **Guide to cable support systems**

---

Widths of 8 and 15 millimetres enable flexible adjustment to different cable trays, cable ladders and cable volumes. With the help of the matching SBV tightening strap locks and 576 spring chuck, the

## **Change the parameters on a cable tray**

---



Hi, I have just started working on Revit and it opens up a lot of options for me. Currently, I am working on cable trays and I am sticking with one

## Cable Management for a Flexible Home Office

---

Cable management for a home office that changes weekly requires a modular approach. Get practical tips on using under-desk trays, reusable ties, and zoned routing for a clean desk.

### Contact Us

---

For datasheets, pricing, or custom optical networking solutions, please visit:  
<https://www.entrenamientointeligente.es>