

Main Distribution Box Electrical Equipment

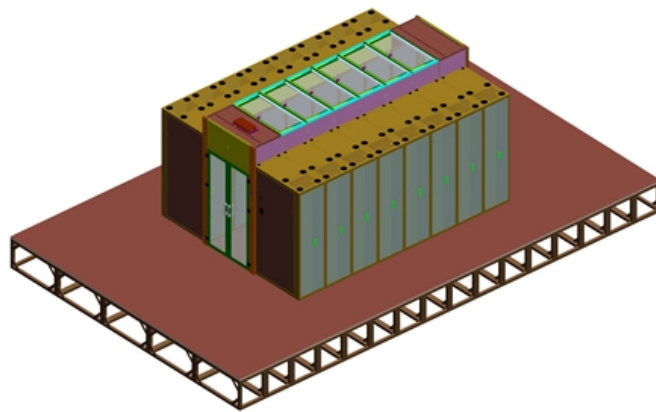



Overview

A Distribution Box, commonly known as a DB Box, serves as the central point for safely distributing electrical power from a main supply to multiple downstream circuits. It houses protective devices such as circuit breakers or fuses, ensuring both equipment protection and user safety. Earthing connection: Ensures proper grounding to maintain safety and system stability. For procurement professionals, electrical contractors, and project managers, choosing the right Distribution Box (DB Box) is a critical decision that directly impacts system safety, reliability, and long-term operating costs. If you have any questions about distribution boxes, please feel free to contact us.



Main Distribution Box Electrical Equipment

Distribution Box Guide: Types, Components & Solutions

What is a Distribution Box? A distribution box, or DB box, is a circuit breaker enclosure. It is a vital part and central hub of any electrical system. The

Complete Guide For Distribution Boxes Types

Distribution boxes, also known as electrical distribution boards or panels, are pivotal components in electrical systems, ensuring the safe and organized distribution of



The Complete Guide to Distribution Box: Installation, Types & More

A distribution box typically refers to the main electrical panel that receives power from the utility service. A sub-panel is a smaller distribution panel fed from the main panel to serve specific

Distribution Board vs. Distribution Box: What's the

Sub-Distribution Boards (SDBs): These take power from the main board and distribute it to specific zones or equipment. For example, a sub-board

Understanding Distribution Boxes: A Comprehensive Guide

A distribution box is used to receive electrical power from a main supply and distribute it to multiple branch circuits in a safe and controlled way. It



DB BOX(Electrical Distribution Box): Everything You

Learn everything you need to know about the Electrical Distribution Box (DB Box). Explore types, materials, installation tips, etc.

Ultimate Guide To Distribution Boxes Db Boxes Types

A Distribution Box is far more than a simple enclosure--it is the backbone of a safe and reliable electrical system. By understanding DB Box types, components, and

Distribution Boxes: Types and Functions



Learn what an electrical distribution box (DB/distribution board) is, its main components (MCB/RCCB/RCBO, SPD, busbar) and common types.

Power Distribution Boxes: A Complete Overview , Eventech

Power distribution boxes, or PDUs, are essential for efficiently distributing electrical power to various equipment and devices in industrial and commercial settings.

Understanding Distribution Boxes:A Comprehensive Guide

Understanding its significance, this article covers what a distribution box is, how it functions, its structure, the various types available, and how it



Power Distribution Boxes Explained Simply

What Is a Power Distribution Box? A power distribution box is a key part of any electrical system--it's the place where electricity from a main source

Distribution Box and Selection Guide

A distribution box, sometimes referred to as a panel board, distribution board, or breaker panel, is an essential part of electrical systems that

Distribution Boxes Explained: Types, Functions, and

Learn about distribution boxes, their types, functions, and safety features to ensure efficient and secure electrical power distribution in any building.



Panelboards and Distribution Panels: What They Are

Introduction Navigating the world of electrical distribution can be confusing, with terms like panelboard, switchboard, and distribution box often

What Is an Electrical Distribution Box? A Complete Guide

An electrical distribution box is a centralized unit responsible for distributing electrical power across multiple circuits within various environments, including residential,



Distribution Boxes: Types and Functions

A distribution boxes acts as the load center and main distributor of electrical power within a building. Also called a distribution board, panel board,

Distribution Boxes Types - The Complete Guide

A commonly used distribution box contains doorbells, earth leakage devices, timers, or contact breakers. However, the distribution boxes have several sizes and designs suitable for

What is an Electrical Distribution Box? A

An electrical distribution box is often called the control hub of a building's electrical system, and for good reason. It's where power from the main



Explore Power Distribution Box Types and Functions

In the distribution box, commonly known as the distribution board or breaker panel, you'll find several critical components responsible for managing

Electric power distribution

A 50 kVA pole-mounted distribution transformer Electric power distribution is the final stage in the delivery of electricity. Electricity is carried from the transmission

Power Distribution Boxes Explained Simply

Benefits of Using a Power Distribution Box A power distribution box keeps your electrical system safe and efficient. Here are its main advantages:



Distribution Box Guide: Types, Components & Solutions

From traditional main circuit breaker panels to innovative smart distribution boxes, the evolution of this essential equipment has significantly

Power Distribution Equipment

Introduction Power Distribution Equipment is a term generally used to describe any apparatus used for the generation, transmission, distribution, or control of electrical energy. This section concentrates

What is the Internal Structure of The Distribution



Box

What is a Distribution Box? Definition A distribution box is an essential electrical component used to manage and control the flow of electricity

Distribution Box: Key Functions, Components, and

Learn everything about the Distribution Box, its key components, and how to choose the right one. Explore our quality products and upgrade your

Contact Us

For datasheets, pricing, or custom optical networking solutions, please visit:
<https://www.entrenamientointeligente.es>